

TRITEC™ INDUCTORS AWG 20 X 7

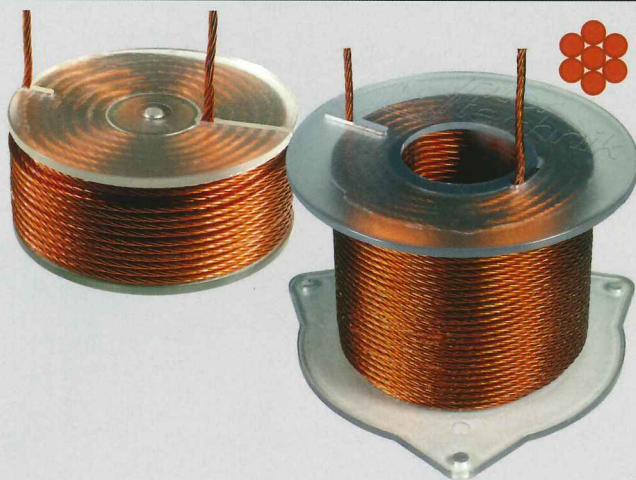

Inductor Configuration

High End inductor
 Thermoplastic copper wire:
 Concentric wire assembly

on a polycarbonate inductor body
 0.80mm Diameter
 with 7 twisted, solitary insulated
 copper conductors
 clockwise
 hexagonal
 Inductor backed and immersed
 100mm
 10mm

Transposition:

Coiling Type:

Specification:

Wire Connection:

Tinned Length:

Characteristics

- Low ohmic resistances
- High quality factor
- Very low skin effect
- No saturation distortion
- No hysteresis distortion
- Constant inductance at current change
- Constant inductance at load changes

Technical Data

- Inductor Body: Polycarbonate (-90 to 135°C)
- Inductance Area: 0.15 mH to 15.0 mH
- L-tolerance: +/- 1%
- Copper Conductor: 99.99% Purity
- Insulation Temperature: 150°C
- Temperature Coefficient: 0.000394 per °C
- Skin Effect Rac = Rdc 27, 18 12

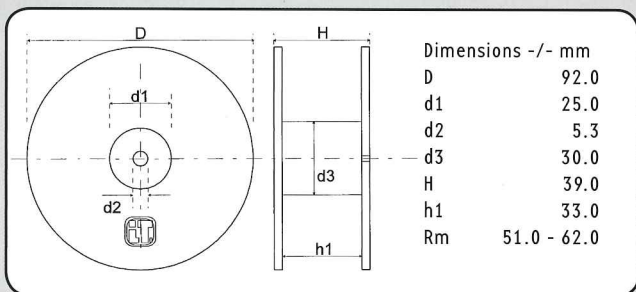

LU 92/39

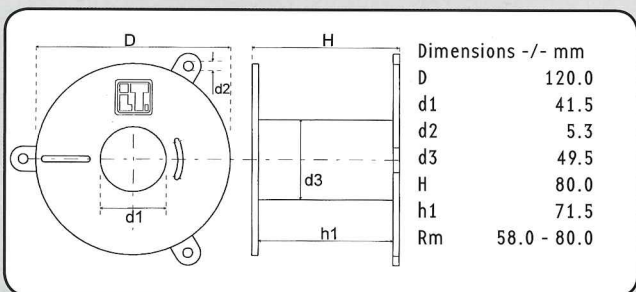

LU 120/80

Tritec Cu. 7 x 0.80 mm; Cross-Section 3.51 mm²

AWG 20 x 7

Description	L/mH	R/0hm	DxH/mm	Order No.
LU 92/0.47 TT/080	0.47	0.111	92x39	150 0282
LU 92/0.56 TT/080	0.56	0.123	92x39	150 0284
LU 92/0.68 TT/080	0.68	0.137	92x39	150 0286
LU 92/0.82 TT/080	0.82	0.150	92x39	150 0287
LU 92/1.00 TT/080	1.00	0.170	92x39	150 0289
LU 120/1.20 TT/080	1.20	0.213	120x55	150 0290
LU 120/1.50 TT/080	1.50	0.240	120x55	150 0292
LU 120/1.80 TT/080	1.80	0.270	120x55	150 0294
LU 120/2.00 TT/080	2.00	0.290	120x55	150 0295
LU 120/2.20 TT/080	2.20	0.316	120x55	150 0296
LU 120/2.70 TT/080	2.70	0.347	120x80	150 0298
LU 120/3.00 TT/080	3.00	0.354	120x80	150 0299
LU 120/3.30 TT/080	3.30	0.361	120x80	150 0300
LU 120/3.90 TT/080	3.90	0.392	120x80	150 0301
LU 120/4.70 TT/080	4.70	0.434	120x80	150 0302
LU 120/5.60 TT/080	5.60	0.488	120x80	150 0303

Technics Tip

The TRITEC INDUCTOR is an absolute High-End Component for the speaker. With the 7 times twisted copper conductor the self capacitance of the inductor is negligible. The usage of thermoplastic wire with an additional inductor immersion creates an audiophile component of highest precision.