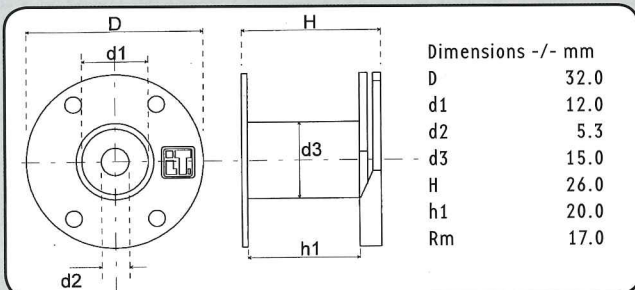
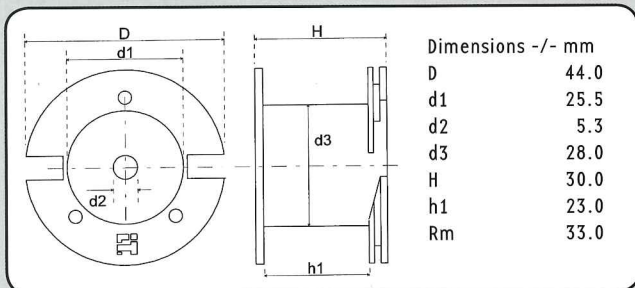
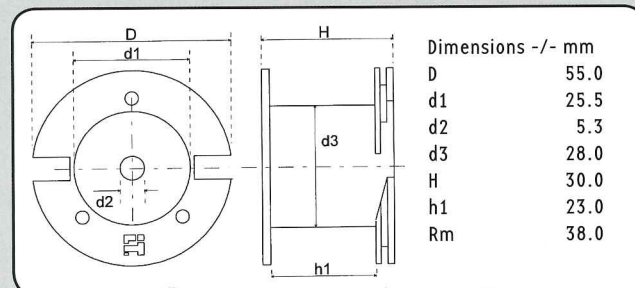

AIR THERM BACKLACK INDUCTORS

Backlack inductors are made from a special coil (thermoplastic coil). An additional layer of varnish is melted on the wire during or after the coiling procedure using hot air or a current impulse. This effect is comparable to impregnation under vacuum. This coiling technique achieves a vibration free inductor coiling.

Copper Wire Ø: 0.90 - 1.32 mm
 Copper Wire: with thermoplastic insulation
 CU Purity: > 99.99 %
 Wire Bonding Length: 50 mm
 Tin Coated Length: 9 mm
 Coil Body Material: Polycarbonat (-90 to +135° C)
 L-tolerance: ± 3 %
 L-Value: Nom. 25° C and 1 kHz

LU 32/26

LU 44/30

LU 55/30

LUT 32/26 • CU 0.90 mm • Cross-Section 0.64 mm ²			AWG 19
Description	L/mH	R/Ohm	Order Number
LUT32/0.10/090	0.10	0.17	134 0600
LUT32/0.12/090	0.12	0.19	134 0602
LUT32/0.15/090	0.15	0.21	134 0604
LUT32/0.18/090	0.18	0.23	134 0606
LUT32/0.22/090	0.22	0.26	134 0608
LUT32/0.27/090	0.27	0.29	134 0610
LUT32/0.33/090	0.33	0.32	134 0612

LUT 44/30 • CU 0.90 mm • Cross-Section 0.64 mm ²			AWG 19
Description	L/mH	R/Ohm	Order Number
LUT44/0.39/090	0.39	0.37	134 0614
LUT44/0.47/090	0.47	0.41	134 0616
LUT44/0.56/090	0.56	0.44	134 0618
LUT44/0.68/090	0.68	0.50	134 0620

LUT 55/30 • CU 0.90 mm • Cross-Section 0.64 mm ²			AWG 19
Description	L/mH	R/Ohm	Order Number
LUT55/0.82/090	0.82	0.54	134 0622
LUT55/1.00/090	1.00	0.61	134 0624
LUT55/1.20/090	1.20	0.67	134 0626
LUT55/1.50/090	1.50	0.76	134 0628
LUT55/1.80/090	1.80	0.84	134 0630

LUT 55/30 • CU 1.32 mm • Cross-Section 1.37 mm ²			AWG 16
Description	L/mH	R/Ohm	Order Number
LUT55/0.47/1.32	0.47	0.21	150 0070
LUT55/0.56/1.32	0.56	0.23	150 0071
LUT55/0.68/1.32	0.68	0.26	150 0072

LUT 62/41 • CU 1.32 mm • Cross-Section 1.37 mm ²			AWG 16
Description	L/mH	R/Ohm	Order Number
LUT62/0.82/132	0.82	0.30	150 0073
LUT62/1.00/132	1.00	0.34	150 0074
LUT62/1.20/132	1.20	0.38	150 0075
LUT62/1.50/132	1.50	0.43	150 0076
LUT62/1.80/132	1.80	0.47	150 0077
LUT62/2.20/132	2.20	0.52	150 0078

LUT 92/39 • CU 1.32 mm • Cross-Section 1.37 mm ²			AWG 16
Description	L/mH	R/Ohm	Order Number
LUT92/2.70/132	2.70	0.59	150 0079
LUT92/3.30/132	3.30	0.66	150 0080
LUT92/3.90/132	3.90	0.72	150 0081
LUT92/4.70/132	4.70	0.81	150 0082